



MICROMOUNTERS OF NEW ENGLAND



The MMNE was organized on November 5, 1966 for the purpose of promoting the study of minerals that require a microscope.

PRESIDENT

Frank Leighton
Templeton Rd. 1
Phillipston, MA 01331

VICE-PRESIDENT

Neil Briggs
RFD #1, Box 94
Brattleboro, VT 05301

SECRETARY

Betty Sevrens
94 Pearl Street
Woburn, MA 01801

TREASURER

Janet Cares
18 Singletary Lane
Sudbury, MA 01776

EDITOR

Shelley N. Monaghan
12 Conant Drive
Brockton, MA 02401

Dues are \$4.00 per year and are due on January 1st, payable to the Treasurer.

Contributions of news items for the Bulletin are welcome and should be sent to the Editor.

This bulletin may be quoted if credit is given. --- Club Address is c/o Editor.

→ NEXT MONTH

The next meeting of the MMNE will be on Saturday, April 4, 1987 at the Hudson Public Library.

MARCH 1987

NEWSLETTER #114

The next regular meeting of the Micromounters of New England will take place on Saturday, March 7, 1987, at Elms College in Chicopee, Mass. We will be meeting in Room 211 in the Administration building. Enter furthest door (see map detail) and take the elevator to the second floor. Room 211 is just off the elevator. You can park at the front door of the building to unload, but parking will be in the parking lot (#12). It has been suggested that if you are coming from East on the Mass Turnpike, Exit 4 is the easiest route to the college. For full directions see maps below.

This is an important issue of the bulletin. This month you will find the REGISTRATION FORM for our NORTHEAST MEETING, which will take place on May 2, 1987. Our speaker will be Dr. Joseph Mandarino, who will talk about minerals of Mont Saint-Hilaire. There will be a surprise visitor as well. Please fill out your registration form as soon as possible in order to reserve your place. Lunch will again be the barbeque-style that we have had in the past two years. Also remember to start gathering specimens for both give-aways and the sales table (mounted and priced) and bring them in as soon as you can. Deadline for registration is April 17th.

Inside this bulletin is our 1987 membership list. If your name is not on this list, and you have not paid your dues by March, this will be the last copy of our bulletin that will be mailed to you.

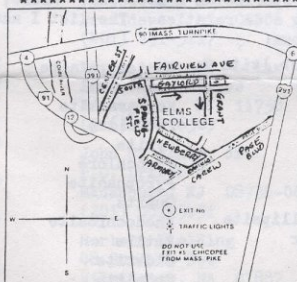

DIRECTIONS

From the North:
Take the North East off at Exit 12 (Rt. 94) and go East off the
94 at Exit 2 (Center Street). Take a right off the ramp, go through
the traffic light and take the first right (Main Street). Continue up
Main St. to the traffic light and take a right to Sprague Street. Elms
College will be on your left.

From the South:
Take the Rt. 94 North East off the Rt. 94 at Exit 12 (Rt. 94). Chicopee
From there follow the directions above.

From the East and West:
Take the Mass Turnpike (Rt. 94) and Exit 4 (Rt. 94) and go East off the
94 at Exit 2 (Center Street) and take a right to Sprague Street. Elms
College will be on your left.

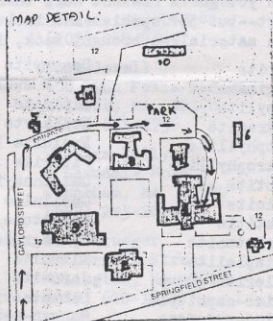

- 1) Administration Building
- 2) College Library
- 3) College Center
- 4) College Chapel
- 5) Chaplain's Residence
- 6) St. Mary's Faculty Residence
- 7) Snodgrass House
- 8) O'Leary Dormitory
- 9) Rose-William Dormitory
- 10) Tennis Court
- 11) Power Plant
- 12) Parking Area

SPECIAL GLOSSARY OFFER TO MMNE MEMBERS

Thanks to fellow MMNE member Jim Grandy, we have the opportunity to purchase the new edition of the Glossary of Mineral Species for \$10 postpaid as opposed to the regular purchase price of \$14.50. However, we need to know how many copies to order by the time of the March meeting. So either let us know at that meeting or mail or phone your request to Janet Cares. Do not send money! Copies will be payable on delivery, perhaps as early as the April meeting, but more likely at the May meeting. You must pick up your copy (or arrange for someone to pick it up for you). There will be no mailed delivery. This is a great chance for those of us who consider the Glossary an indispensable tool.

ATLANTIC MICROMOUNTERS CONFERENCE

The Micromineralogists of the National Capital Area have again sent us information regarding their Micromounters Conference. The conference will take place on April 3, 4, and 5, 1987. The pre-conference reception (on the 3rd) will be held at the Smithsonian's Museum of Natural History. The Saturday and Sunday sessions will take place at the Adult Education Center of Maryland University, Adelphi Road, University Boulevard and Campus Drive, College Park, Maryland. Speakers will include Dr. Dan Appelman of the Smithsonian talking about U.S. sponsored research voyages (in which J. D. Dana played a prominent role); Dr. Lance Kearns talking about selected Virginia localities; Bob Jaxel talking on Minerals of Cornwall; and Lou Perloff showing a suite of his micromount slides. For further information, there will be registration information available at our March meeting. Deadline for registration is March 23, 1987.

FROM THE FEBRUARY ISSUE OF THE TRIASSIC VALLEY BULLETIN: THE MAGIC LIVES ON

In the hey-day of collecting at DeMix Quarry, Mt. St-Hilaire was, on occasion, referred to as "the Magic Mountain". The New Haven Mineral Club members who made a return visit October 4, 1986, after a 5-year absence, found there had been no end to the magic....Collecting today is in the Poudrette Quarry; DeMix is inactive and closed to visitors. Toward the end of one season, the rock available to collectors one week-end was likely to be gone the next. As exasperating as that might be in some ways, it does mean that something new is likely to be available the next time...Where else can you go to collect more than 50 species on a week-end? Micro, true, for the most part--but 50+ species and including some rarities. The list I made after looking over the material we brought back, follows:

| | | | | |
|-----------------|-------------------------|----------------|--------------------------|---------------------|
| Albite | Donayite (prob.) with ? | Monteregianite | Tetranatrolite | |
| Aegirine | ? = ewaldite | Muscovite | Titanite | |
| Ancylite | Elpidite | Narsarsukite | Vesuvianite | |
| Andradite | Eudialyte | Pectolite | Villiaumite | |
| Apophyllite | Ewaldite ? | Pyrite | Sodalite variety | |
| Astrophyllite | Fluorite | Pyrochlore | hackmanite | |
| Biotite | Gaidonnayite | Pyrophanite | Zircon | |
| Calcite | Gmelinite | Quartz | | |
| Apatite | Harmotome/Phillipsite | Rhodochrosite | Other species found this | |
| Carletonite | Hydrogrossular | Rutile | summer: | |
| Catapleiite | Ilmenite | Siderite | Anatase | Genthelvite |
| Chlorite group | Jarosite | Sodalite | Marcasite | Nenadkevichite |
| Clino-amphibole | Labuntsovite | Sphalerite | Pyrrhotite | Gypsum |
| Clino-pyroxene | Mangan-neptunite | Natrolite | Epididymite | Bavenite |
| Dawsonite | Molybdenite | Strontianite | Epididymite | Tadzhikite (UK39) |
| Dolomite | Monazite | Saectite group | Willemite | Hochelagaite (UK50) |

From an article by Marcelle Weber